

# ALTER SOFT LIGHTS QVS2GOLOP232 OR 332

2' X 4' RECESSED DIRECT/INDIRECT FLUORESCENT 2 OR 3 LAMP, T8  
5-1/2" DEEP CURVED OPAL LENS LAMP SHIELD, STATIC

## Features

- Efficiency 80.2% (3 lamp T8).
- Swing down lamp shield for easy relamping and maintenance.
- Soft white opal lens conceals lamp image and provide balance between reflected light and direct light.
- Fully recessed luminaire and lamp compartment.
- 95% Reflective Alter soft white paint finish.
- Specular interior reflector.
- One piece body for easy installation.
- Easy access to ballast through lamp compartment.



## Mounting Methods / Features

Ceiling compatibility

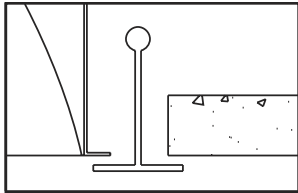

Suited to standard exposed T-grid ceilings

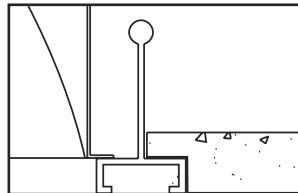

Suited to standard exposed Slot T-grid ceilings

Curved opal lens lamp shield



## Dimensions

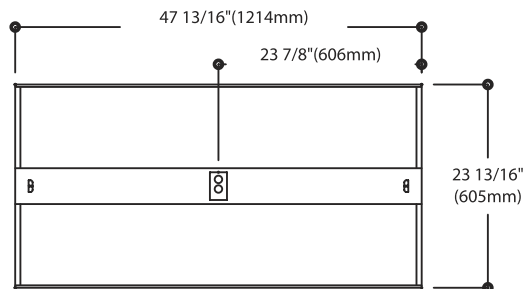
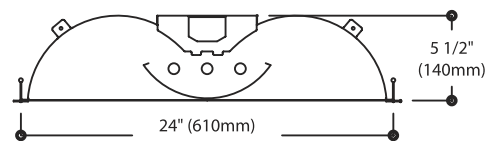
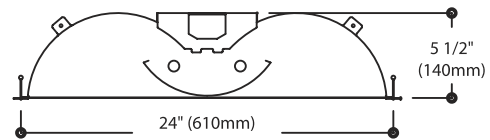

### Job Information

### Type:

**Job Name:**  
**Cat. No.:**

**Lamp(s):**  
**Volts/Ballast:**

**Lightolier** a Genlyte Thomas Company  
 Technical Information: (978) 657-7600 - (978) 658-0595  
 631 Airport Road, Fall River, MA 02720 - (508) 679-8131  
 C.F.I. Division of Canlyte, Inc.  
 525 Education Road, Cornwall, Ontario, Canada K6H 6C7 - (613) 938-6221  
 We reserve the right to change details of design, materials and finish.  
 © 2006 Genlyte Thomas Group LLC (Lightolier Division)  
 A0902

Folio L30-42

**LIGHTOLIER®**

# ALTER SOFT LIGHTS QVS2GOLOP232 OR 332

## 2' X 4' RECESSED DIRECT/INDIRECT FLUORESCENT 2 OR 3 LAMP, T8 5-1/2" DEEP CURVED OPAL LENS LAMP SHIELD, STATIC

### Photometry

Model No. : QVS2GOLOP33212003

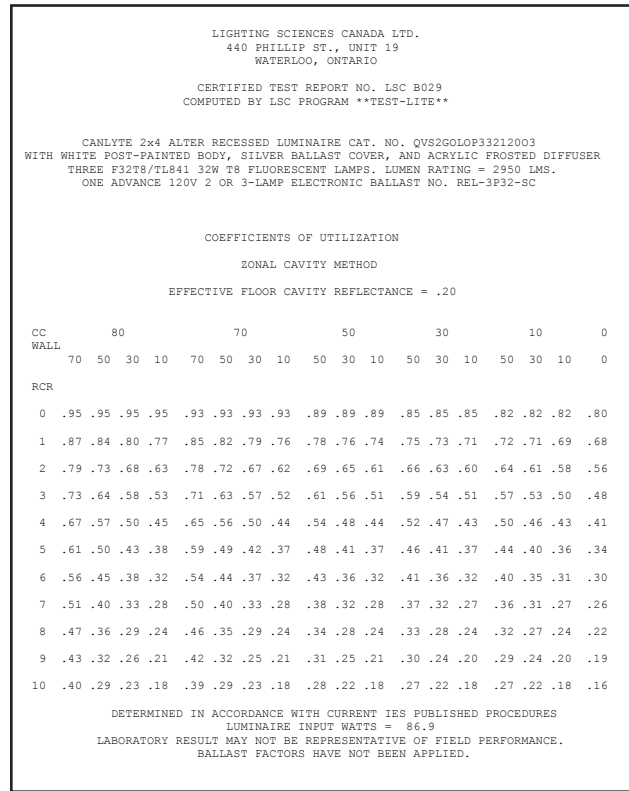
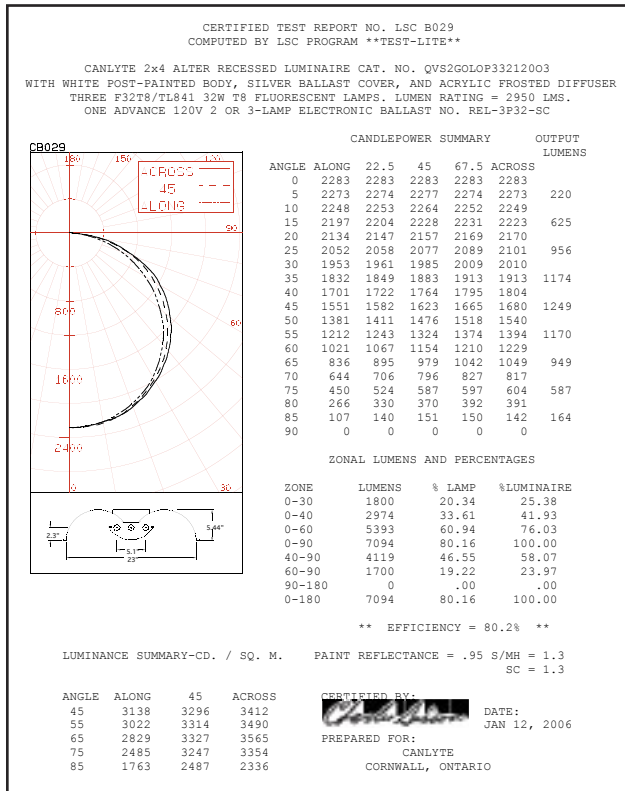

### Ordering Information Explanation of Catalogue Number Example: QVS2GOLOP33212003

<b>QVS</b> QUALITY VISUAL STATIC Recessed direct indirect soft light optical system	<b>2</b> FIXTURE WIDTH 2'	<b>G</b> CEILING TYPE Standard exposed T-grid ceilings	<b>OL</b> LAMP SHIELD OL = Curved opal lens	<b>OP</b> LAMP SHIELD DETAIL OP = One piece (no center slot)	<b>3</b> LAMP QUANTITY 3	<b>32</b> LAMP/FIXTURE LENGTH (NOMINAL 48") 32 = 32W T8	<b>VOLTAGE</b> 120V 277V 347V	<b>BALLAST</b> OC = Magnetic T8 O3 = Electronic T8 instant start 3LPB* R3 = Electronic rapid start 3LPB* PS = PowerSpec HDF Dimming T8 * LPB: Lamp per ballast	<b>OPTIONS</b> R = Radio Interference Filter O = Emergency Lighting System (for Canada) N = Emergency Lighting System (for U.S.)
---	---------------------------------	--	---	--	--------------------------------	---	--	---	---

### SPECIFICATIONS

**MATERIALS:** One piece chassis constructed from die formed 20 gauge cold rolled steele. Reflectors - 95% reflectance baked white acrylic matte paint finish. Specular aluminum interior reflector. Soft curved opal lens conceals lamp image.

**FINISH:** Chassis exterior - phosphate undercoating, baked white acrylic matte paint finish.

**ELECTRICAL:** Rapid start HPF, thermally protected class "P" ballast (Bi-tube type). If K.Os are within 3" of ballast use wire suitable for at least 90C.

**LABELS:** Listed by CSA, UL

### Job Information

Type:

Lightolier a Genlyte Thomas Company

Technical Information: (978) 657-7600 - (978) 658-0595

631 Airport Road, Fall River, MA 02720 - (508) 679-8131

C.F.I. Division of Canlyte, Inc.

525 Education Road, Cornwall, Ontario, Canada K6H 6C7 - (613) 938-6221

We reserve the right to change details of design, materials and finish.

© 2006 Genlyte Thomas Group LLC (Lightolier Division)

A0902

Folio L30-42

LIGHTOLIER®