

HP90 Recessed Fluorescent **H9S2GLR117 or 217**

Page 1 of 2

Direct/Indirect – 2' x 2' with Acrylic Linear Prismatic Lens
Static, 2 Lamp T8

Features

- 74.6% efficient (2 lamp, 17W).
- 72.5% efficient (1 lamp, 17W).
- Direct/indirect appearance with soft contoured interior.
- Lens encloses lamp compartment.
- Translucent DR acrylic linear prismatic lens.
- Tension screws secure ends to body.
- Same fixture fits both G and T ceiling types.
- Fits flush to face of slot grid (T) ceiling types.
- Lamp shield opens from either side.
- 95% reflective specular aluminum reflector.
- Ballast accessible from room side*.
- Built-in earthquake clips.
- Can be continuous row mounted.
- Wiring access plate standard.
- Optional DALI ballast iGEN TECHNOLOGY accepts digital dimming controllers, scene controllers and automatic control devices.
- Construction to meet NYC Code or Chicago Plenum available.

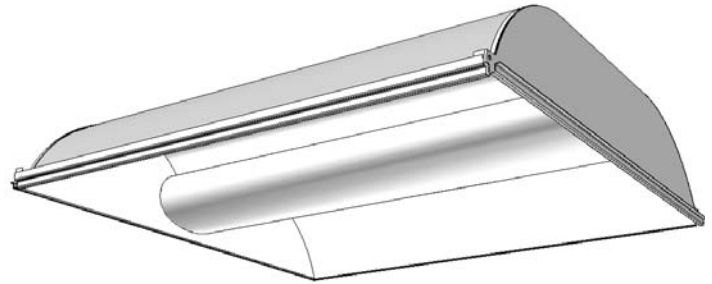

Mounting Methods

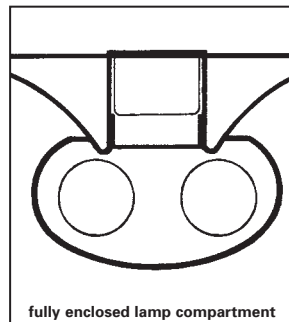
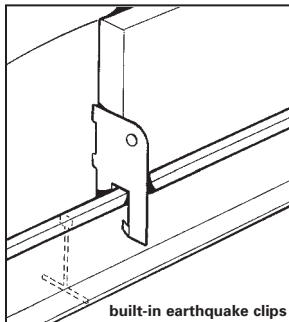
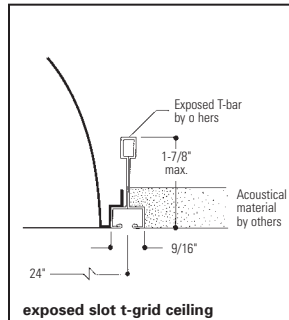
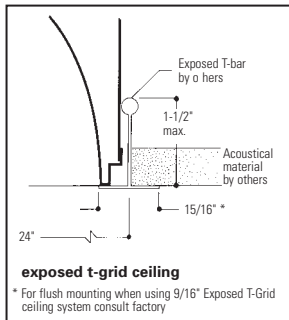

* If emergency pack or 2nd ballast are used access is gained through the adjacent ceiling tile.

Dimensions

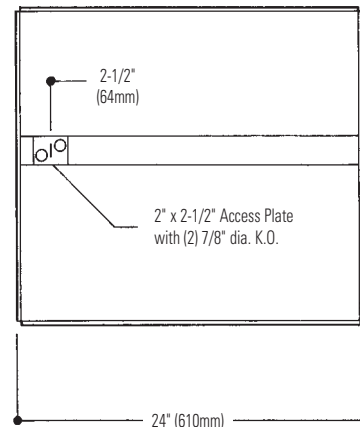
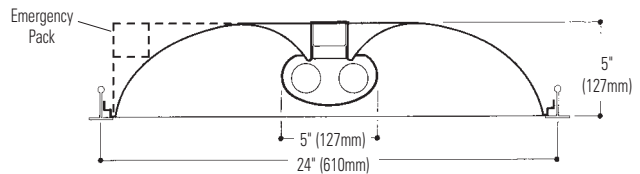

Job Information	Type:
Job Name:	
Cat. No.:	
Lamp(s):	
Volts/Ballast:	

Lightolier a Genlyte company www.lightolier.com
 Technical Information: (978) 657-7600 • Fax (978) 658-0595
 631 Airport Road, Fall River, MA 02720 • (508) 679-8131 • Fax (508) 674-4710
 We reserve the right to change details of design, materials and finish.
 © 2007 a Genlyte company **Section 5/Folio M32-17**

HP90 Recessed Fluorescent H9S2GLR117 or 217

Model No. H9S2GLR117120S0

LER = FP - 48.7 IW - 17.96 BF - 0.88
Comparative yearly lighting ene gy cost per
1000 lumens = \$4.92

Report Number: G2007124
Catalog Number: H9S2GLR117120S0
Lamps: (1) F17 T8
Luminaire: HP90 2' x 2' with linear
prismatic lens.
Ballast: REL1P-32-SC (Advance)
Report is based on 1375 Lumens per lamp.
Efficiency: 72.5%
CIE Type-Direct-Indirect
Plane: 0-Deg 90-Deg
Spacing Criteria: 1.2 1.4
Shielding Angles: 90 90
Plane: 0-Deg 90-Deg
Luminous Length: 22.800 22.800

CANDELA DISTRIBUTION

	0.0	45.0	90.0	FLUX
0	316	316	316	
5	314	315	317	30
15	298	307	314	87
25	271	290	307	134
35	233	265	292	165
45	186	231	269	177
55	133	190	237	168
65	80	143	199	140
75	37	89	114	85
85	8	8	7	12
90	2	2	1	

COEFFICIENTS OF UTILIZATION – ZONAL CAVITY METHOD. EFFECTIVE FLOOR CAVITY REFLECTANCE 0.20

RC	80	50	30	10	50	30	10
1	79	75	72	70	68	66	66
2	71	65	60	57	54	52	52
3	65	57	51	48	44	41	41
4	59	50	43	42	38	35	35
5	54	44	38	42	36	32	32
6	50	40	33	38	32	28	28
7	46	36	30	34	29	25	25
8	43	33	27	31	26	22	22
9	40	30	24	29	23	20	20
10	38	28	22	27	21	18	18

LUMINANCE DATA IN CANDELA/SQ. METER

AVERAGE IN DEG.	AVERAGE 0-DEG.	AVERAGE 45-DEG.	AVERAGE 90-DEG.
45	708.	879.	1023.
55	624.	891.	1112.
65	509.	910.	1267.
75	385.	925.	1185.
85	247.	247.	216.

Model No. H9S2GLR217120S0

LER = FP - 56.6 IW - 31.9 BF - 0.88
Comparative yearly lighting ene gy cost per
1000 lumens = \$4.24

Report Number: G2007120
Catalog Number: H9S2GLR217120S0
Lamps: (2) F17 T8
Luminaire: HP90 2' x 2' with linear
prismatic lens.
Ballast: B2321120RH-A (Universal)
Report is based on 1375 Lumens per lamp.
Efficiency: 74.6%
CIE Type-Direct-Indirect
Plane: 0-Deg 90-Deg
Spacing Criteria: 1.2 1.5
Shielding Angles: 90 90
Plane: 0-Deg 90-Deg
Luminous Length: 22.800 22.800

CANDELA DISTRIBUTION

	0.0	45.0	90.0	FLUX
0	615	615	615	
5	612	615	617	59
15	586	605	618	171
25	539	580	616	267
35	470	538	603	337
45	382	482	563	368
55	276	405	491	353
65	164	309	407	294
75	73	193	230	177
85	16	17	14	26
90	3	2	2	

COEFFICIENTS OF UTILIZATION – ZONAL CAVITY METHOD. EFFECTIVE FLOOR CAVITY REFLECTANCE 0.20

RC	80	50	30	10	50	30	10
1	81	77	74	72	70	67	67
2	73	67	61	63	58	55	55
3	66	58	52	55	49	45	45
4	60	51	44	48	43	38	38
5	55	45	38	43	37	33	33
6	51	41	34	39	33	28	28
7	47	37	30	35	29	25	25
8	44	33	27	32	26	22	22
9	41	31	24	29	24	20	20
10	38	28	22	27	22	18	18

ZONAL LUMEN SUMMARY

ZONE	LUMENS	% LAMP	% FIXT
0-30	496	18.1	24.2
0-40	833	30.3	40.6
0-60	1555	56.5	75.8
0-90	2052	74.6	100.0
90-180	0	0.0	0.0
0-180	2052	74.6	100.0

LUMINANCE DATA IN CANDELA/SQ. METER

AVERAGE IN DEG.	AVERAGE 0-DEG.	AVERAGE 45-DEG.	AVERAGE 90-DEG.
45	1453.	1834.	2142.
55	1294.	1899.	2303.
65	1044.	1967.	2591.
75	759.	2006.	2390.
85	494.	525.	432.

Ordering Information

Explanation of Catalog Number. Example: H9S2GLR217UNVHI

<div style="border: 1px solid black; width: 40px; height: 20px; margin: 0 auto;"></div> <p>HP90 Direct/Indirect Recessed</p>	<div style="border: 1px solid black; width: 40px; height: 20px; margin: 0 auto; text-align: center;">S</div> <p>Body Style: S = Static</p>	<div style="border: 1px solid black; width: 40px; height: 20px; margin: 0 auto; text-align: center;">2</div> <p>Fixture Width</p>	<div style="border: 1px solid black; width: 40px; height: 20px; margin: 0 auto; text-align: center;">G</div> <p>Ceiling Type: Fits both Standard Grid and Slot Grid</p>	<div style="border: 1px solid black; width: 40px; height: 20px; margin: 0 auto; text-align: center;">L</div> <p>Acrylic Lens</p>	<div style="border: 1px solid black; width: 40px; height: 20px; margin: 0 auto; text-align: center;">R</div> <p>Reflector: Specular Aluminum</p>	<div style="border: 1px solid black; width: 40px; height: 20px; margin: 0 auto;"></div> <p>Lamp Quantity 1=1 Lamp 2=2 Lamp</p>	<div style="border: 1px solid black; width: 40px; height: 20px; margin: 0 auto; text-align: center;">17</div> <p>Lamp: (By Others) 17=T8 17W (Nominal 24")</p>	<div style="border: 1px solid black; width: 40px; height: 20px; margin: 0 auto;"></div> <p>Voltage: 120, 277 or UNV=120-277</p>	<div style="border: 1px solid black; width: 40px; height: 20px; margin: 0 auto;"></div> <p>Options: Add appropriate suffix to catalog no., i.e. (GLR)</p>
<p>Ballast Type: <20THD <10THD SO* HI* PS -</p> <p>1 or 2 Lamp Elec. T8 LOL Dimming T8 *Instant Start Standard Other dimming options. Consult factory. NOTE: For T8 UNV, you must use HI Ballast Code.</p>									
H9	Standard HP90								
HY	For NYC Code – I.B.E.W. Manufactured								
HN	For NYC Code – Local 3 Manufactured								

Options/Accessories

Fusing: Internal fast blow fusing: SUFFIX: **GLR**.
Internal slow blow fusing: SUFFIX: **GMF**.
Drywall Kit: Order Catalog Number: **FK92X2**.
Electrical Wiring Options: Consult factory.
For motion or light sensor. See Folio OA20-10.

Specifications

Performance: In an installation of 2 lamp 17W luminaires in a room cavity ratio of 1, with reflectance 80% ceiling, 50% wall, 20% floor, the C.U. shall not be less than .89. To reduce glare the average brightness at 65° shall not exceed 2591 candelas per square meter. To control veiling reflections, luminaire output in the 30°-90° zone shall not be less than 75.8%.

Materials: Chassis parts are die-formed code gauge steel.
Lamp Shield: Linear prismatic translucent DR acrylic lens.
Finish: Chassis exterior – baked white polyester enamel. Cavity – baked white polyester enamel. Rust preventative undercoating. Reflector – low iridescence specular aluminum .95% reflectance.

Specifications (continued)

Electrical: Thermally protected class "P" ballast C.B.M. approved, non PCB. If K.O. is within 3" of ballast, use wire suitable for at least 90°. UL Listed for damp locations.
Labels: I.B.E.W./UL and ULc Listed.
This product may have a mercury containing lamp. Manage in accord with Disposal Laws. See: www.lamprecycle.org

Job Information Type:

Lightolier a Genlyte company www.lightolier.com
Technical Information: (978) 657-7600 • Fax (978) 658-0595
631 Airport Road, Fall River, MA 02720 • (508) 679-8131 • Fax (508) 674-4710
We reserve the right to change details of design, materials and finish.
© 2007 a Genlyte company **Section 5/Folio M32-17**

LIGHTOLIER®