

# Calculite® HID Adjustable Accent **C4T4GA-MHT4RNF**

Page 1 of 4

4 1/2" Aperture, T4 Ceramic Metal Halide Glasslite, Narrow Flood

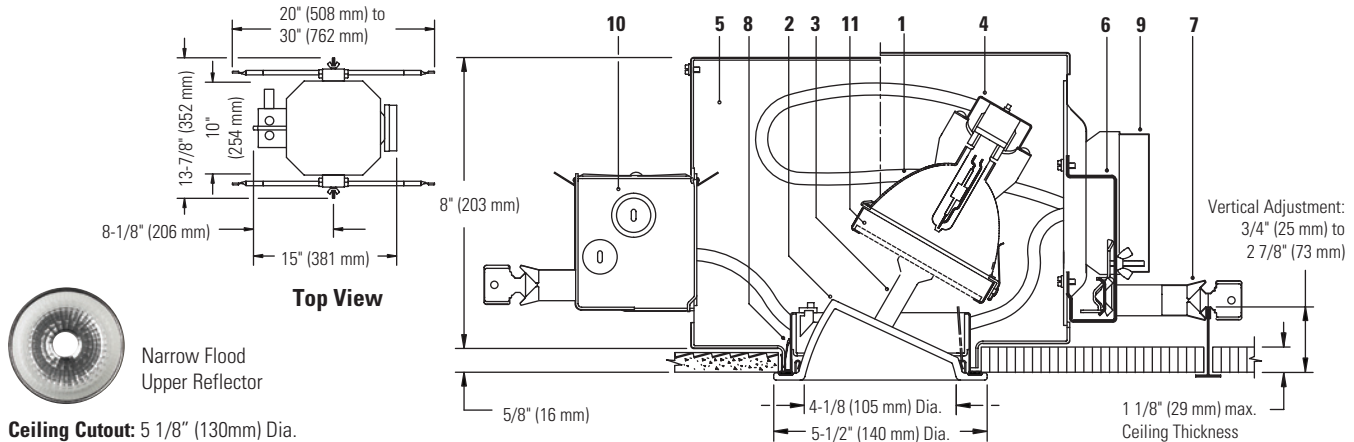

**For Complete Fixture Order: Glasslite Trim Kit + Narrow Flood Upper Reflector (MHT4RNF) + Frame-In Kit. Each Sold Separately.**

Glasslite Trim Kit + Narrow Flood Upper Reflector	Frame-In Kit	Lamping (Ceramic Metal Halide)
<b>C4T4GA + MHT4RNF (Narrow Flood Upper Reflector)</b> Etched glass, with matching flange.	<b>C4A20BT5PGJ5E1</b> <b>C4A20T4GU65EU</b> <b>C4A20T4EU</b> <b>C4A39T4GU65EU</b> <b>C4A39T4E1</b> <b>C4A39T4E2</b> <b>C4A70T4E1</b> <b>C4A70T4E2</b>	Electronic 120V Electronic 120V/277V Electronic 120V/277V Electronic 120V/277V Electronic 120V Electronic 277V Electronic 120V Electronic 277V
	Electronic 120V Electronic 120V/277V Electronic 120V/277V Electronic 120V/277V Electronic 120V Electronic 277V Electronic 120V Electronic 277V	22W Philips MiniMasterColor 20W GE ConstantColor 20W T4.5 39W Philips MiniMasterColor 39W T4.5 39W T4.5 70W T4.5 70W T4.5

## Features

- Narrow Flood Upper Reflector:** Specular split faceted aluminum; provides 25° beam. Interchangeable with 12° Spot (MHT4RS) and 40° Flood (MHT4RF); see spec sheets C4T4GA-MHT4RS and C4T4GA-MHT4RF.
- Glasslite Trim Kit: One piece borosilicate etched glass.**
- Trim Kit Adjustment Mechanism:** Provides 35° vertical tilt, 360° horizontal rotation; lockable. EZ-Aim Helical Drive System provides fast and accurate hot aiming with Philips screwdriver.
- Socket Housing:** Galvanized steel, pre-wired with G8.5 pulse rated socket. Snaps onto yoke for secure attachment without tools; unitized construction assures proper alignment of lamp to optics for consistent optical performance.
- Frame Housing:** Steel, 0.029" (22-Ga.), matte black finish. Removable cover for top re-lamping.
- Frame Vertical Adjustment Mechanism:** Accommodates mounting to virtually any ceiling system using pre-installed mounting bars, or 1/2" EMT tubing (by others). Single locking feature secures all adjustments. Alignment holes and markings allow fixture to be pre-set prior to installation. Final adjustment can be made from below from inside fixture.
- Mounting Bars:** Galvanized steel, 0.048" (18-ga.), pre-installed telescoping bars extend to 30" long and lock securely into position. Built-in locking tabs provide positive attachment to common T-bar systems. Self-centering feature simplifies installation in 24" O.C. grid systems. Attaches to steel or wood joists without accessories.
- Retention Springs:** Rust resistant springs secure trim for quick, tool-less installation.
- Ballast / Cover Assembly:** Accessible from below and removable without tools for inspection and ballast replacement.
- Junction Box:** 0.059" (16-ga.) galvanized steel. UL listed for 8 No. 12 AWG, 90°C through branch circuit conductors. Allows inspection from below.
- Accessory Holder:** Sold separately catalog # CAH4; die-formed steel, matte black finish, slide-in installation. Accepts up to two 3 3/4" dia. media.

## Features (continued)

- Thermal Protector:** (Not Shown) Meets NEC and UL requirements. Do not install insulation above nor within 3" (76mm) of any part of the luminaire.

## Electrical

**Electrical Ballast:** 120V or 277V, 50/60 Hz., enclosed, high power factor, T.H.D. <15%, thermally and transient protected, RMI/RFI complies with FCC Part 18 non-consumer limits, shut-down circuit at end of lamp life, sound rating "A", -5° F minimum starting temperature, Type 1 Outdoor rating.

Ballast	ANSI Code	Voltage	Max. Amps	Input Watts
20W MH	M156	120/277	0.21/0.10	23
39W MH	M130	120/277	0.39/0.17	44
70W MH	M139	120/277	0.67/0.29	78

## Options and Accessories

Chicago Plenum: Consult Factory

## Labels

UL (Suitable for Wet Locations), CSA, I.B.E.W.

## Job Information

Type:

Job Name:

Cat. No.:

Lamp(s):

Notes:

# Calculite® HID Adjustable Accent **C4T4GA-MHT4RNF**

(FC) is initial footcandles at center of beam.  
 Beam length (L) and beam width (W) are to where the candlepower is reduced to 50% of the center beam candlepower. (C) is the distance to the center of the beam.

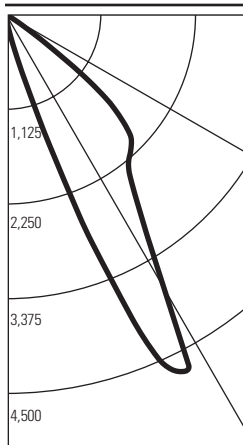
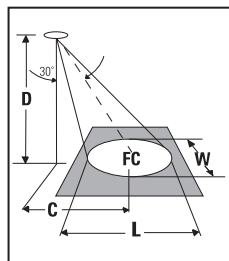

ANGLE	WALL
0	29
5	51
10	159
15	627
20	2536
25	4649
30	3750
35	2710
40	2265
45	2104
50	1549
55	423
60	53
65	8
70	4
75	2
80	2
85	0
90	0

AIMED 30 deg. TOWARD WALL  
 LAMP: T4.5 CERAMIC MH, GE  
 LUMEN RATING: 1700  
 CBCP: 4649  
 BEAM ANGLE: 20  
 AROMAT 20W ELECTRONIC BALLAST  
 DATE: APR 14, 2004  
 CERTIFIED TEST REPORT NO. 18683  
 COMPUTED BY LSI PROGRAM  
 \*\*TEST-LITE\*\*

20W T4.5 Ceramic MH, Narrow Flood Upper Reflector

30° Aiming Angle  
Horizontal Surface

D	C	FC	L	W
6'	3.5'	84	2.9'	2.4'
8'	4.6'	47	3.8'	3.3'
10'	5.8'	30	4.8'	4.1'
12'	6.9'	21	5.7'	4.9'
15'	8.7'	13	7.1'	6.1'

30° Aiming Angle  
Vertical Surface

D	C	FC	L	W
2'	3.5'	145	3.1'	1.4'
3'	5.2'	65	4.7'	2.1'
4'	6.9'	36	6.2'	2.8'
6'	10.4'	16	9.3'	4.2'
8'	13.9'	9	12.4'	5.6'

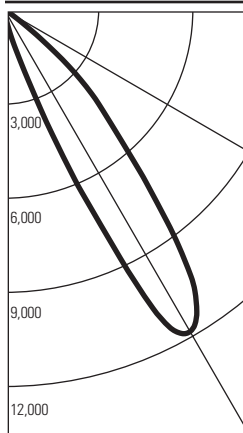

ANGLE	WALL
0	68
5	106
10	293
15	1082
20	3335
25	8723
30	11830
35	10356
40	6699
45	4256
50	2126
55	529
60	94
65	24
70	19
75	12
80	7
85	0
90	0

AIMED 30 deg. TOWARD WALL  
 LAMP: T4.5 CERAMIC MH, PHILIPS  
 LUMEN RATING: 3400 LMS.  
 CBCP: 11830  
 BEAM ANGLE: 19  
 AROMAT 39W ELECTRONIC BALLAST  
 DATE: APR 13, 2004  
 CERTIFIED TEST REPORT NO. 18684  
 COMPUTED BY LSI PROGRAM  
 \*\*TEST-LITE\*\*

39W T4.5 Ceramic MH, Narrow Flood Upper Reflector

30° Aiming Angle  
Horizontal Surface

D	C	FC	L	W
8'	4.6'	120	3.6'	3.1'
10'	5.8'	77	4.5'	3.9'
12'	6.9'	53	5.4'	4.6'
15'	8.7'	34	6.8'	5.8'
20'	11.5'	19	9.0'	7.7'

30° Aiming Angle  
Vertical Surface

D	C	FC	L	W
3'	5.2'	164	4.4'	2.0'
4'	6.9'	92	5.8'	2.7'
6'	10.4'	41	8.8'	4.0'
8'	13.9'	23	11.7'	5.4'
12'	20.8'	10	17.5'	8.0'

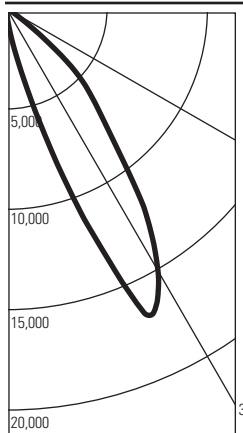

ANGLE	WALL
0	193
5	553
10	1781
15	4736
20	10855
25	16862
30	15070
35	11695
40	7850
45	5720
50	3136
55	879
60	161
65	34
70	23
75	16
80	5
85	0
90	0

AIMED 30 deg. TOWARD WALL  
 LAMP: T4.5 CERAMIC MH, PHILIPS  
 LUMEN RATING: 6200 LMS  
 CBCP: 16862  
 BEAM ANGLE: 21  
 AROMAT 70W ELECTRONIC BALLAST  
 DATE: APR 2, 2004  
 CERTIFIED TEST REPORT NO. 18685  
 COMPUTED BY LSI PROGRAM  
 \*\*TEST-LITE\*\*

70W T4.5 Ceramic MH, Narrow Flood Upper Reflector

30° Aiming Angle  
Horizontal Surface

D	C	FC	L	W
8'	4.6'	171	4.0'	3.4'
10'	5.8'	110	5.0'	4.3'
12'	6.9'	76	6.0'	5.1'
15'	8.7'	49	7.5'	6.4'
20'	11.5'	27	10.0'	8.6'

30° Aiming Angle  
Vertical Surface

D	C	FC	L	W
3'	5.2'	234	5.0'	2.2'
4'	6.9'	132	6.6'	3.0'
6'	10.4'	59	9.9'	4.4'
8'	13.9'	33	13.2'	5.9'
12'	20.8'	15	19.8'	8.9'

**Job Information** **Type:**

# Calculite® HID Adjustable Accent **C4T4GA-MHT4RNF**

**22W PGJ5** Philips MiniMastercolor CMH Lamp, **Narrow Flood** Upper Reflector, Lumen Rating = 1650 lms, Aromat Electronic Ballast

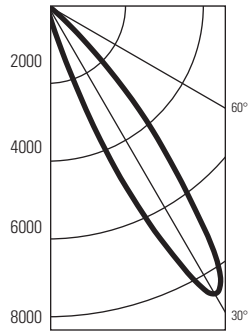

Angle	Wall
0	42
5	79
10	237
15	631
20	2672
25	6161
30	8557
35	7052
40	4206
45	1728
50	394
55	53
60	16
65	0
70	2
75	0
80	0
85	0
90	0

30° Aiming Angle					30° Aiming Angle				
Horizontal Surface					Vertical Surface				
D	C	FC	L	W	D	C	FC	L	W
6'	3.5'	154	2.6'	2.2'	2'	3.5'	267	2.7'	1.3'
8'	4.6'	87	3.4'	2.9'	3'	5.2'	119	4.1'	1.9'
10'	5.8'	56	4.3'	3.7'	4'	6.9'	67	5.5'	2.5'
12'	6.9'	39	5.1'	4.4'	6'	10.4'	30	8.2'	3.8'
15'	8.7'	25	6.4'	5.5'	8'	13.9'	17	11.0'	5.1'

Certified Test Report No. 3934FR, Date: Oct 16, 2008. Computed by LSI Program \*\*Test-Lite\*\*

**39W PGJ5** Philips MiniMastercolor CMH Lamp, **Spot** Upper Reflector, Lumen Rating = 3000 lms, Aromat Electronic Ballast

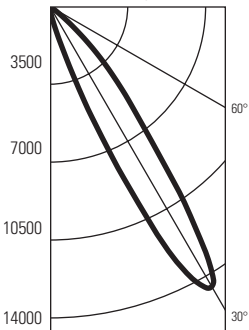

Angle	Wall
0	64
5	138
10	453
15	1320
20	4515
25	10967
30	14542
35	9984
40	5497
45	2375
50	1016
55	172
60	28
65	0
70	0
75	0
80	0
85	0
90	0

30° Aiming Angle					30° Aiming Angle				
Horizontal Surface					Vertical Surface				
D	C	FC	L	W	D	C	FC	L	W
6'	3.5'	262	2.3'	1.9'	2'	3.5'	454	2.4'	1.1'
8'	4.6'	148	3.0'	2.6'	3'	5.2'	202	3.6'	1.7'
10'	5.8'	94	3.8'	3.2'	4'	6.9'	114	4.8'	2.2'
12'	6.9'	66	4.5'	3.9'	6'	10.4'	50	7.2'	3.4'
15'	8.7'	42	5.7'	4.9'	8'	13.9'	28	9.6'	4.5'

Certified Test Report No. 3939FR, Date: Oct 16, 2008. Computed by LSI Program \*\*Test-Lite\*\*

**Job Information** **Type:**

# Calculite® HID Adjustable Accent **C4T4GA-MHT4RNF**

**20W GU6.5** GE Constantcolor CMH Lamp, **Narrow Flood** Upper Reflector, Lumen Rating = 1615 lms, Aromat Electronic Ballast

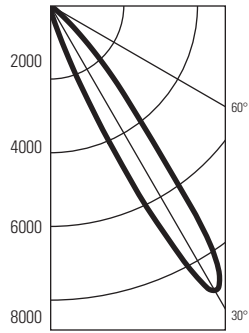

Angle	Wall
0	45
5	75
10	226
15	484
20	1834
25	5517
30	8932
35	6669
40	3037
45	1306
50	375
55	72
60	21
65	5
70	2
75	0
80	0
85	0
90	0

30° Aiming Angle Horizontal Surface					30° Aiming Angle Vertical Surface				
D	C	FC	L	W	D	C	FC	L	W
6'	3.5'	161	2.0'	1.7'	2'	3.5'	279	2.1'	1.0'
8'	4.6'	91	2.6'	2.3'	3'	5.2'	124	3.1'	1.5'
10'	5.8'	58	3.3'	2.8'	4'	6.9'	70	4.1'	2.0'
12'	6.9'	40	3.9'	3.4'	6'	10.4'	31	6.2'	2.9'
15'	8.7'	26	4.9'	4.3'	8'	13.9'	17	8.2'	3.9'

Certified Test Report No. 3930FR, Date: Oct 16, 2008. Computed by LSI Program \*\*Test-Lite\*\*

**39W GU6.5** GE Constantcolor CMH Lamp, **Narrow Flood** Upper Reflector, Lumen Rating = 3400 lms, Aromat Electronic Ballast

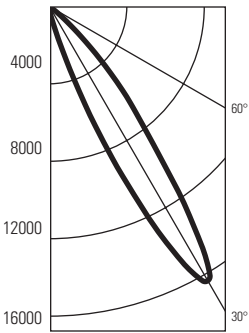

Angle	Wall
0	97
5	202
10	568
15	1573
20	5387
25	11827
30	16362
35	11447
40	6503
45	3050
50	880
55	139
60	43
65	6
70	6
75	0
80	0
85	0
90	0

30° Aiming Angle Horizontal Surface					30° Aiming Angle Vertical Surface				
D	C	FC	L	W	D	C	FC	L	W
6'	3.5'	295	2.3'	1.9'	2'	3.5'	511	2.4'	1.1'
8'	4.6'	166	3.0'	2.6'	3'	5.2'	227	3.6'	1.7'
10'	5.8'	106	3.8'	3.2'	4'	6.9'	128	4.8'	2.2'
12'	6.9'	74	4.5'	3.9'	6'	10.4'	57	7.2'	3.4'
15'	8.7'	47	5.7'	4.9'	8'	13.9'	32	9.6'	4.5'

Certified Test Report No. 3933FR, Date: Oct 16, 2008. Computed by LSI Program \*\*Test-Lite\*\*

<b>Job Information</b>	<b>Type:</b>
------------------------	--------------