

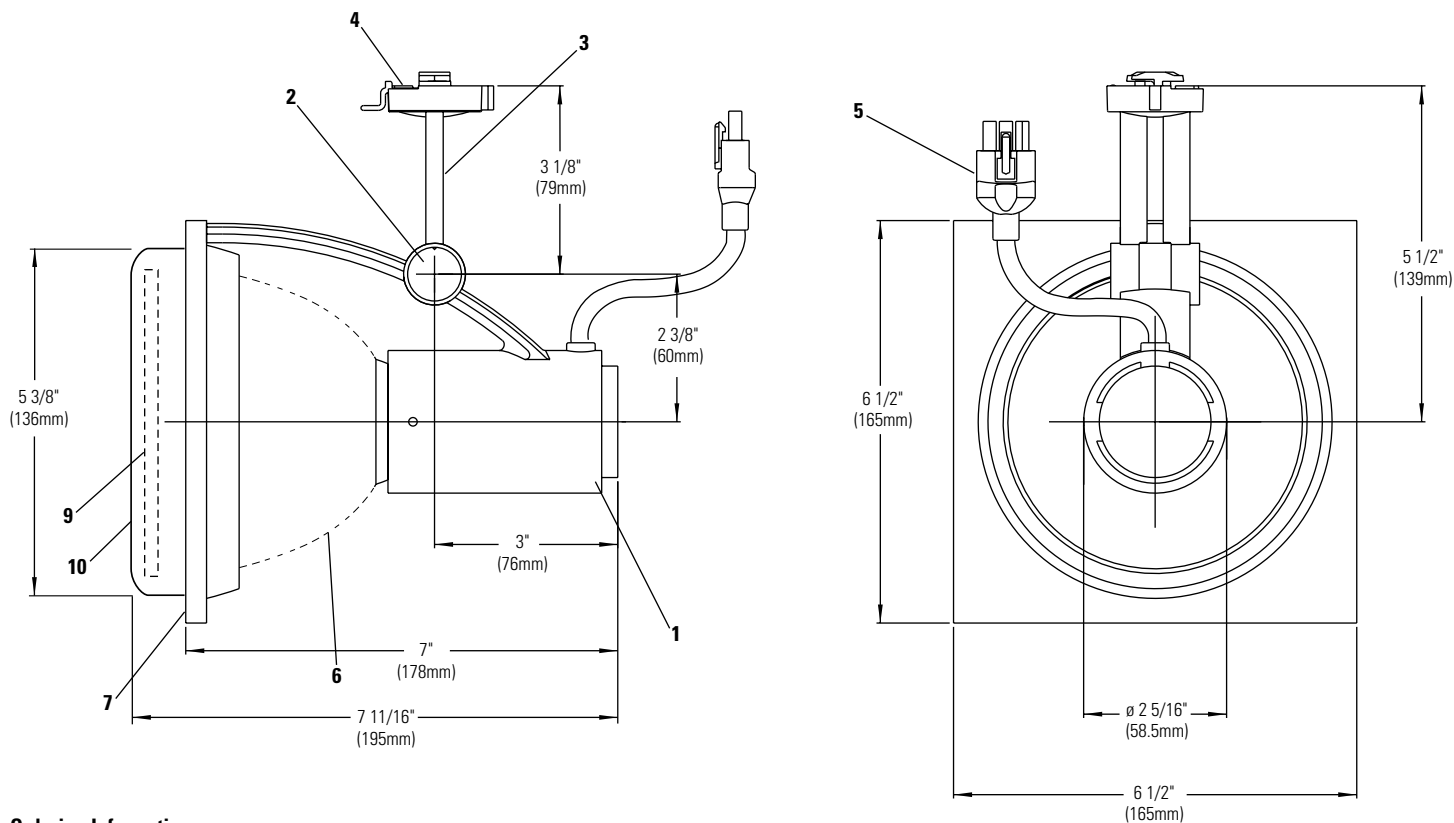

Lytespan® Track Lighting System **8307U**

Page 1 of 1

PowerArc™ Modular Metal Halide 70W, 100W ED-17 Open Spot
For Unprotected or Protected Lamp



Ordering Information

Catalog No.	Finish	Track Mountings	Ballast Module	Lamp	Reflectors
8307UWH	Matte White	All Lytespan® Track systems and Multipoint. All PowerArc™ Modular canopies, extension wands, mounting brackets or pipe clamps. Not compatible with ProSpec® or ATOM®.	Use one of:	ED17 or E17 Clear, Unprotected or Protected Ceramic Metal Halide 100W Max.	Use one of: 83ED17RNS 83ED17RS 83ED17RF 83ED17RWF
8307UBK	Matte Black		83B70E 83B70M		
8307UAL	Metallic Aluminum		83B10E 83B10M 83CY70E 83B70SE		

Features

- Housing:** Die cast aluminum body.
 - Vertical Pivot:** 0-90° vertical adjustment.
 - Horizontal Pivot:** Die cast track adapter with infinite rotation.
 - Track Attachment Fitting:** Molded polycarbonate rotates into track.
 - Power Connector:** 5kv rated with insulated pins. Connects to ballast module. Keyed for polarity.
 - Reflector:** Interchangeable reflectors available to allow for desired precise beam spread without the need of additional lenses.
 - Square Frame:** Die cast aluminum. Accepts Accessory Holders.
 - Socket:** (not shown) 5kv pulse rated ceramic body socket with nickel plated lamp contacts.
 - Protective Glass:** 1/8" thick tempered glass. Can be replaced with filter.
 - Accessory Holder:** steel holds (2) filters (1) piece of glass must always be installed.
- Reflectors sold separately. See **83ED17R NS/S/F/WF** specification sheets.

Accessories

ADF4 (4 3/4" dia.)	Color Filters	} Compatible with 83B70E and magnetic ballasts only
AF4	Diffusion Filters	
AL4HC	Hex Cell Louver	
83EW18WH, BK, AL	18" Extension Wand	
83EW48WH, BK, AL	48" Extension Wand	
83EC72WH, BK	6' Extension Cord	
83PCWH, BK	Pipe Clamp	
83MPTWH, BK	Mounting Bracket	

Finish

All painted finishes are baked enamel.

Electrical

See ballast module spec sheet.

Labels

UL, cUL

Job Information

Type:

Job Name:

Cat. No.:

Lamp(s):

Notes:

Lightolier a Genlyte company www.lightolier.com
631 Airport Road, Fall River, MA 02720 • (508) 679-8131 • Fax (508) 674-4710
We reserve the right to change details of design, materials and finish.
© 2006 Genlyte Group LLC • D1106

LIGHTOLIER®